

MSU Campus Archaeology Program Survey Summary Sheet



Survey No. 33

Date of Survey: August 6 - 7, 2009

Site Name: Art Museum

Principal Investigator: Terry Brock

Physical Plant Project Name:

Project Justification: Unknown - likely alterations / demolition of main Kresge Art Museum building when it was to be replaced by the Broad.

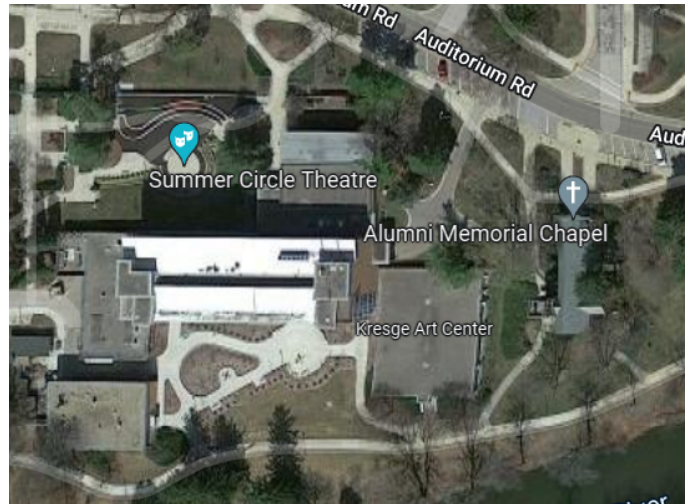

Location: Auditorium Road

Campus Zone: South Campus

Survey Type: Shovel Test Survey

Methodology: Three judgmental shovel test pits (see field map)

Summary/Conclusions: The project area described in this summary report is the location of the Kresge Art Museum which was established in 1959 (Kresge Art Museum 2011). This area of campus was included in the original land purchase from A. R. Burr that established MSU in 1855 (Akey 2020). However, the portion of campus east of Farm Lane was not developed by the university until the 20th century, with a veterinary building visible on the 1914-5 campus maps, a bit to the north of the project area in this report.. What is now the Fairchild Auditorium is visible in the area on the 1941 campus map and the Kresge is visible on the 1965 campus map. These seem to be the first campus buildings constructed in the area, but it is likely that the space may have been used as agricultural fields at some point prior to the mid-20th century.

Recommendations and Priority: Archaeological survey and monitoring did not identify any archaeological materials in the area. Additional shovel testing is not required, but CAP recommends archaeologists monitor any ground disturbing construction in the area.

Field Notes:

- STP 1

- 45 cmbs
- No cultural material
- encountered an ash layer at ~40 cmbs
- STP 2
 - 40 cmbs
 - No cultural material
 - possible buried A-horizon soil
- STP 3
 - 45 cmbs
 - No cultural material

Field Map:

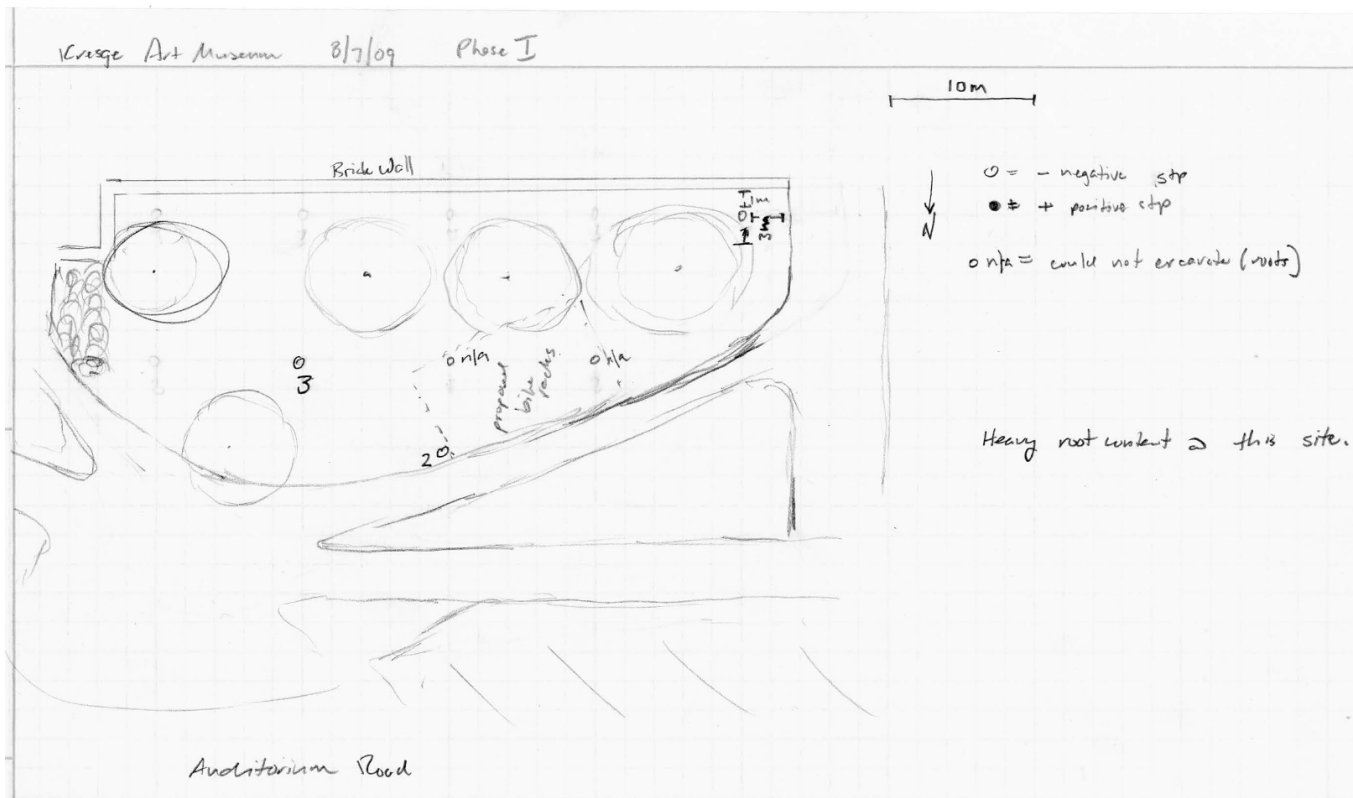

Citations:

Akey, Benjamin (2020) Historic Farmsteads Summary: MSU Land Acquisitions 1855-1935. Campus Archaeology Program, Michigan State University, East Lansing, MI

Kresge Art Museum (2011) Facebook page

<https://www.facebook.com/Kresge-Art-Museum-52023843817/>